

Use and maintenance instructions

TURBO INCANTO TCP06 CANOPY HOOD



CE

INDEX

1 - USER INSTRUCTIONS	PAGE 3
1.1 CONTROL PANEL	PAGE 3
1.2 SAFETY	PAGE 3
1.3 CLEANING	PAGE 3
2 - MAINTENANCE INSTRUCTION	PAGE 4
2.1 - WARNINGS	PAGE 4
2.2 - ANTI-GREASE FILTERS	PAGE 4
2.3 - CARBON FILTERS	PAGE 5
2.4 - LIGHTING	PAGE 6
3 - INSTALLING INSTRUCTIONS	PAGE 7
3.1 GENERAL	PAGE 7
3.2 SAFETY	PAGE 7
3.3 COMPONENTS	PAGE 7
3.4 INSTALLATION	PAGE 8
4 - CONSTRUCTION AND TECHNICAL SPECIFICATIONS	PAGE 13
4.1 TECHNICAL CHARACTERISTICS	PAGE 13
4.2 GENERAL	PAGE 13

**DISPOSAL OF OLD ELECTRICAL
APPLIANCES**

The European Directive 2002/96/EC on Waste Electrical and Electronic Equipment (WEEE), requires that old household electrical appliances must not be disposed off in the normal unsorted municipal waste stream. Old appliances must be collected separately. In order to optimise the recovery and recycling of the material they contain and reduce the impact on human health and the environment. The crossed out "wheeled bin" symbol on the product reminds you of your obligation, that when you dispose off the appliance it must be separately collected. Consumers should contact their local authority or retailer for information concerning the correct disposal of their old appliances.

1 - USER INSTRUCTIONS

1.1 - CONTROL PANEL

- A - 3 way aspirating switch
- B - Intake warning light
- C - light switch

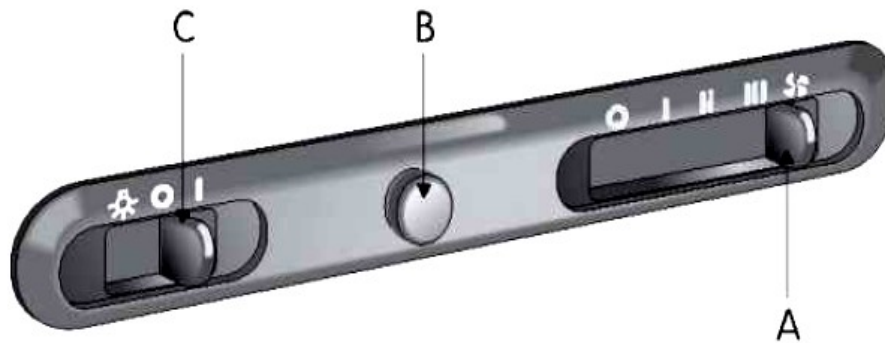

1.2 - SAFETY

- A - Constantly check oil overheating while using the deep fryer in order to prevent it from catching fire.
- B - Before carrying out any cleanign operation disconnect the appliance by unplugging it or by switching off the circuit breaker.
- C - In the case in which the hood and other apparatuses that emit fumes are being used in the room, do not switch on the hood. The room needs to be aerated.
- D - Do not leave the cooker on if it is not being used.
- E - The hood is designed to remove the kitchen smells, any other additional use shall be regarded as non-intended.
- F - It is advisable to turn on the hood before starting to cook and leave it on for approx. 15 minutes after or at least until the smell is completely removed.

1.3 - CLEANING

- Use only a damp cloth with neutral liquid detergent
- Do not use wet sponges or cloths, water jets, thinners, solvents, alcohol or abrasive substances.

2 - MAINTENANCE

2.1 - WARNING

Unplug the appliance or switch off the circuit breaker before carrying out maintenance operations.

2.2 - METALLIC ANTI-GREASE FILTER

- The filter must be washed at least once a month with hot water and household detergent.
- It can also be washed in the dishwasher.
- Open by means of the handles.(Fig 1A/B)



Fig. 1A

2.3 - ACTIVATED CARBON FILTERS (Only filtering types) (sold aside)

- The filters cannot be regenerated therefore they must be replaced.
- To replace the filters:
 - Disassemble the metal anti-grease filters.
 - Rotate the filter for approx. 90° and remove it.
 - For assembly, slide the new filter in the nib on the side of the motor and then rotate it for approx. 90 degrees (Fig 2)



Fig. 2

2.4 - LIGHTING (Fig 3)

To substitute the mounted lamps :

- Unscrew the lateral screw
- Remove the ceiling light making it slide towards the right or left
- Unscrew the lamp or lamps to be substituted (Fig 3A)

HALOGEN LIGHTING

- Rotate the light unit anti-clockwise
- Remove the light unit (Fig 3B)
- Replace the lamp with one that has the same features because one with more power may cause severe damage to the electrical system



Fig. 3A

3 - INSTALLATION INSTRUCTIONS

3.1 - GENERAL INFORMATION

This hood is constructed for built-in design. It can be used on the ASPIRATING types (external exhaust) or on the FILTERING types (internal recycling). We suggest to have installation carried out by qualified personnel, in compliance with all the current regulations and in particular with the ones concerning air exhaust. The manufacturer cannot be held liable for damages caused by improper installation or if it has not been carried out according to the state-of-the-art.

3.2 - SAFETY

- A - Do not connect the appliance discharge to exhaust ducts of smokes produced by combustion that is not supplied by electrical power.
- B - The minimum safety distance between the cooking counter and the hood is 65cm.
- C - In the case in which both the hood and apparatuses emit fumes do not switch on the hood. A sufficient aeration of the setting needs to be created.

3.3 - COMPONENTS

- A - Reduction fitting dia 150/120
- B - Complete hood casing
- C - Filter holding grid
- D - Bag with accessories and screws

COMPONENTS

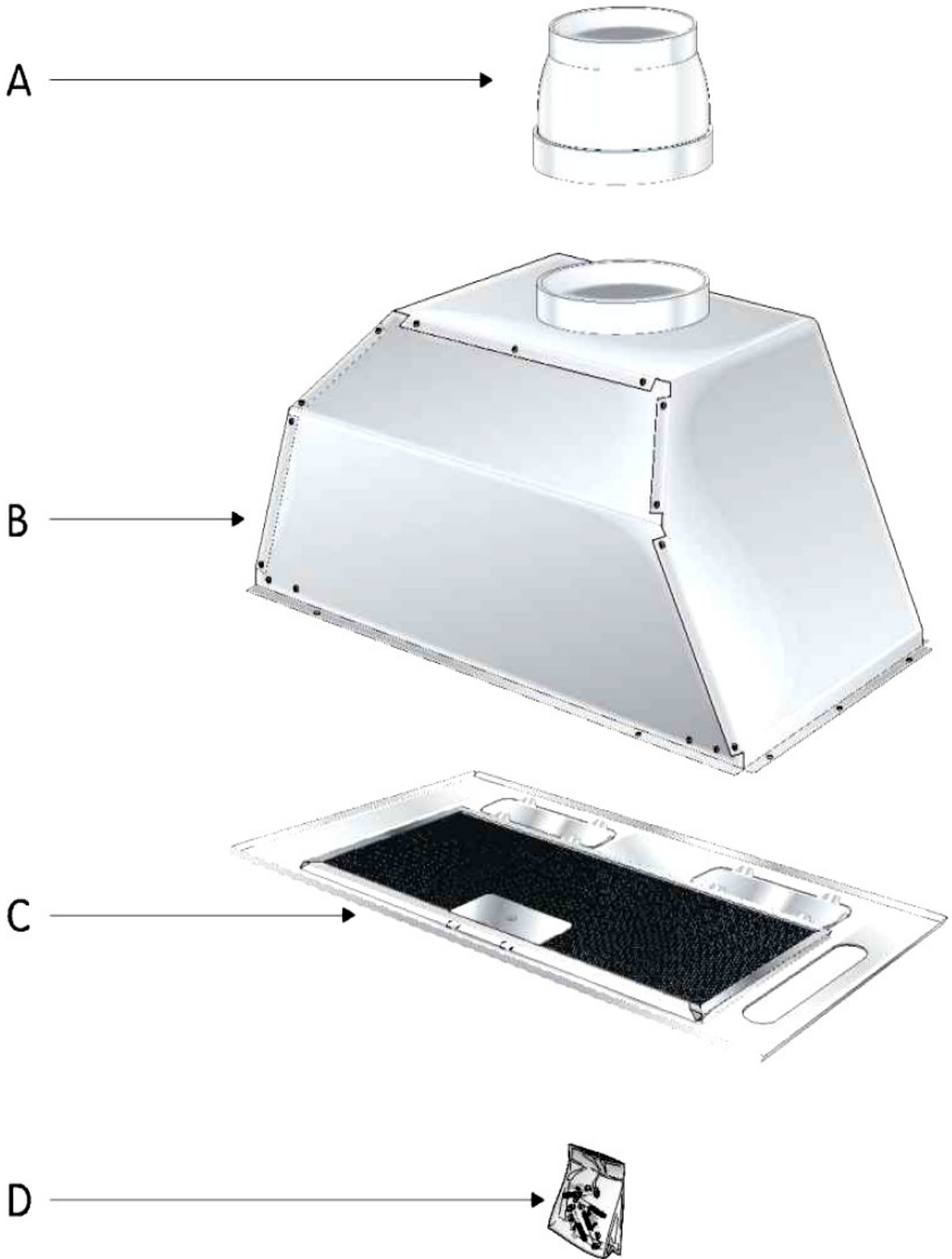

3.4 - INSTALLATION

A - HOW TO POSITION THE HOOD CASING (FILTERING TYPE)

- Mount the 120/150 reduction fitting whenever the air discharge tube is \varnothing 120.
- The diameter of the air outlet pipe must not be less than 120mm.
- Assemble the activated carbon filters (optional).
- Fix the hood to the unit using the 8 screws supplied M4 x 10 steel, M4, 2 x30 wood, together with the 4 screws for attachment to the panel.

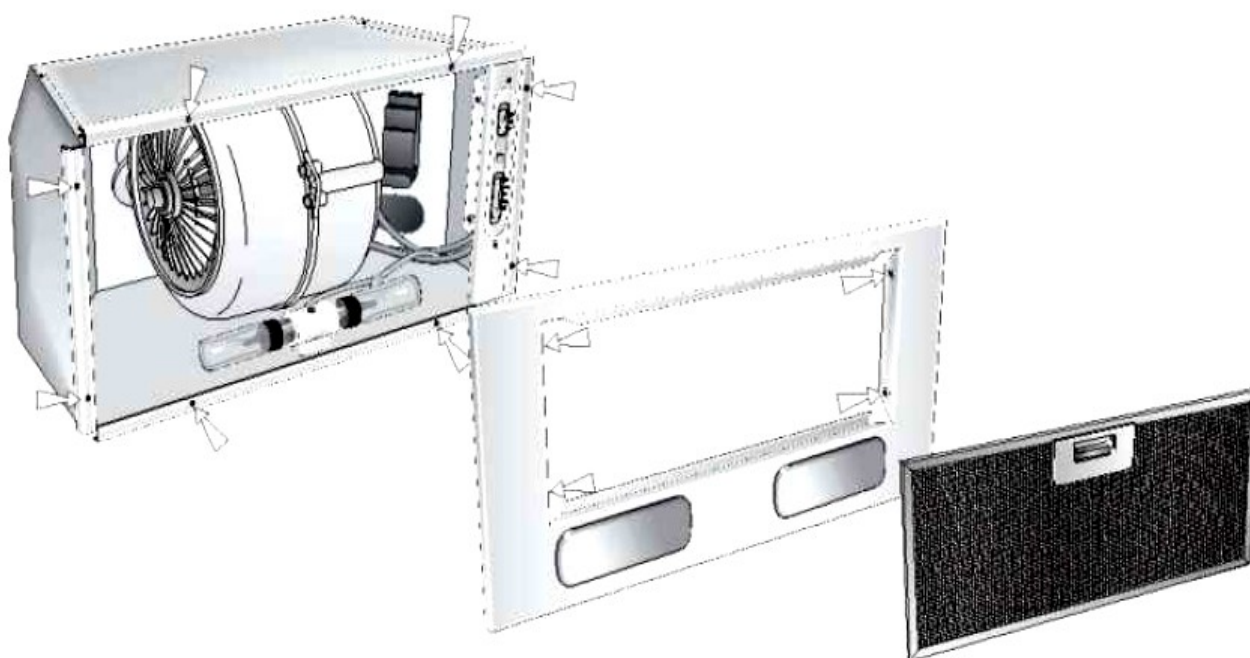

B - HOW TO POSITION THE HOOD CASING (ASPIRATING TYPE)

- Mount the 120/150 reduction fitting whenever the air discharge tube is \varnothing 120.
- Apply a flexible pipe over the lip of the reduction connection for external exhaust and fix it with a pipe tightening ring.
- Disassemble the activated carbon filters (if already assembled).
- Drill a 260 x 495mm slot on the lower part of the casing.
- Anchor the hood to the casing by means of the eight M3.9 x 9.5 screws included in the supply.
- Connect the scavenging pipe to the outdoor duct and fix it with a pipe-tightening ring.

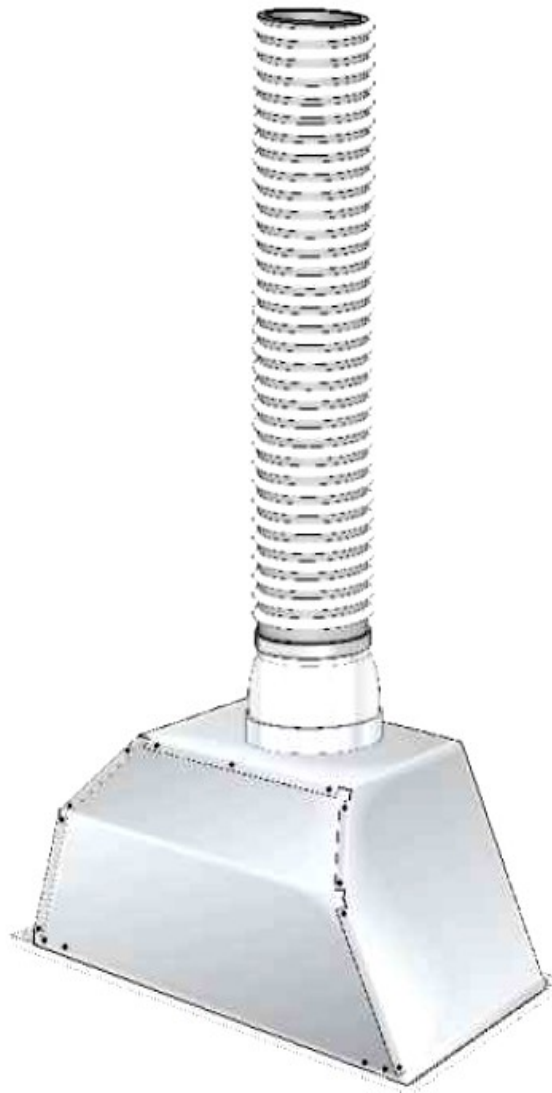

F - HOW TO CONNECT TO THE ELECTRICAL MAIN

Check to see that the main voltage complies with the one required by the hood, which is indicated by the hood, which is indicated on the tag that is applied on the internal side of the appliance.

Assemble a suitable plug on the wire or insert a proper power 2- poles switch if it is to be directly connected to the main with a 3mm minium opening between contacts between the main and the appliance. All the above-mentioned electrical parts must comply with the current standards. The yellow/green earthing cable (if included) must not be interrupted.

G - OPERATIGN CHECKS : (fig 4)

Check lights and motor start-up on all 3 speeds.

Reassemble the lower filter holding frame by means of the 4 screws.

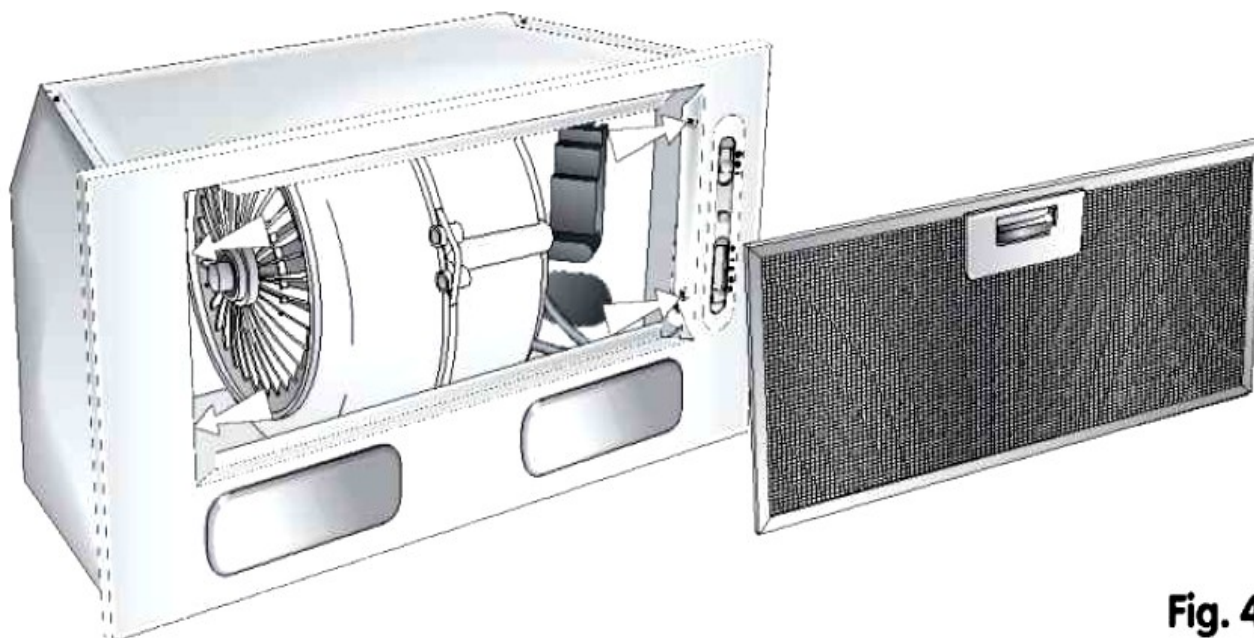
**Fig. 4**

4 - CONSTRUCTION AND TECHNICAL SPECIFICATIONS

4.1 CONSTRUCTION CHARACTERISTICS

- Stainless steel sheet body Sp. 6/10
- Steel bearing body painted with black and white.

4.2 GENERAL CHARACTERISTICS

- Electrical system according to the international regulations
- 3 operating speeds
- Activated carbon filter with high depurating qualities (filtering types)(sold aside)
- Cooking counter lighting system
- Reference standards according to the E.M.C. 89/336 : EN55014, En60555-2 Directives
- Reference standards according to the L.V.D. 73/23, with Int. 93/68 : EN60335-1, En60335-2-31 Directives

WIRING DIAGRAM SLIDER COMMANDS INCANDESCENT LIGHT ILLUMINATION

